

## Bijlage 2 Lijst met waarneempunten- en hoogtes ten behoeve van de dove gevels

Lijst dove gevels bestaande bebouwing en maximale benutting lege kavels

wnp	hoogte [m]	wnp	hoogte [m]	wnp	hoogte [m]	wnp	hoogte [m]	wnp	hoogte [m]
18-1	< 5m	20-1	> 20m	23-4	5 - 10m	59-3	> 20m	63-2	> 20m
18-1	5 - 10m	20-2	> 20m	23-4	10 - 20m	59-4	> 20m	63-4	< 5m
18-1	10 - 20m	20-4	< 5m	23-4	> 20m	59-A	> 30m	63-4	5 - 10m
18-1	> 20m	20-4	5 - 10m	24-4	5 - 10m	59-B	> 55m	63-4	10 - 20m
18-2	< 5m	20-4	10 - 20m	24-4	> 10m	60-1	< 5m	63-4	> 20m
18-2	5 - 10m	20-4	> 20m	44-1	< 5m	60-1	5 - 10m	63-A	> 55m
18-2	10 - 20m	21-1	< 5m	44-1	5 - 10m	60-1	10 - 20m	64-1	10 - 20m
18-2	> 20m	21-1	5 - 10m	44-1	10 - 20m	60-1	> 20m	64-1	> 20m
18-4	< 5m	21-1	10 - 20m	44-1	> 20m	60-2	> 20m	64-2	< 5m
18-4	5 - 10m	21-1	> 20m	44-2	< 5m	60-4	> 20m	64-2	5 - 10m
18-4	10 - 20m	21-2	< 5m	44-2	5 - 10m	60-5	< 5m	64-2	10 - 20m
18-4	> 20m	21-2	5 - 10m	44-2	10 - 20m	60-5	5 - 10m	64-2	> 20m
18-A	< 5m	21-2	10 - 20m	44-2	> 20m	60-5	10 - 20m	64-3	5 - 10m
18-A	5 - 10m	21-2	> 20m	44-4	5 - 10m	60-5	> 20m	66-1	> 20m
18-A	10 - 20m	21-3	< 5m	44-4	10 - 20m	62-1	5 - 10m	66-3	> 20m
18-A	> 20m	21-3	5 - 10m	44-4	> 20m	62-1	10 - 20m	67-1	5 - 10m
18-B	> 55m	21-3	10 - 20m	44-5	< 5m	62-1	> 20m	67-1	> 20m
19-1	< 5m	21-3	> 20m	44-5	5 - 10m	62-2	5 - 10m	67-2	5 - 10m
19-1	5 - 10m	22-1	< 5m	44-5	10 - 20m	62-2	10 - 20m	67-2	10 - 20m
19-1	10 - 20m	22-1	5 - 10m	44-5	> 20m	62-2	> 20m	67-2	> 20m
19-1	> 20m	22-1	10 - 20m	49-4	5 - 10m	62-4	5 - 10m	67-3	10 - 20m
19-4	5 - 10m	22-1	> 20m	50-2	5 - 10m	62-4	10 - 20m	68-2	10 - 20m
19-4	10 - 20m	22-4	< 5m	50-5	5 - 10m	62-4	> 20m	68-2	> 20m
19-4	> 20m	22-4	5 - 10m	51-2	5 - 10m	63-1	< 5m	68-3	10 - 20m
20-1	< 5m	22-4	10 - 20m	51-4	< 5m	63-1	5 - 10m	68-3	> 20m
20-1	5 - 10m	22-4	> 20m	51-4	5 - 10m	63-1	10 - 20m	68-5	> 20m
20-1	10 - 20m	23-4	< 5m	59-1	> 20m	63-1	> 20m	68-6	> 20m

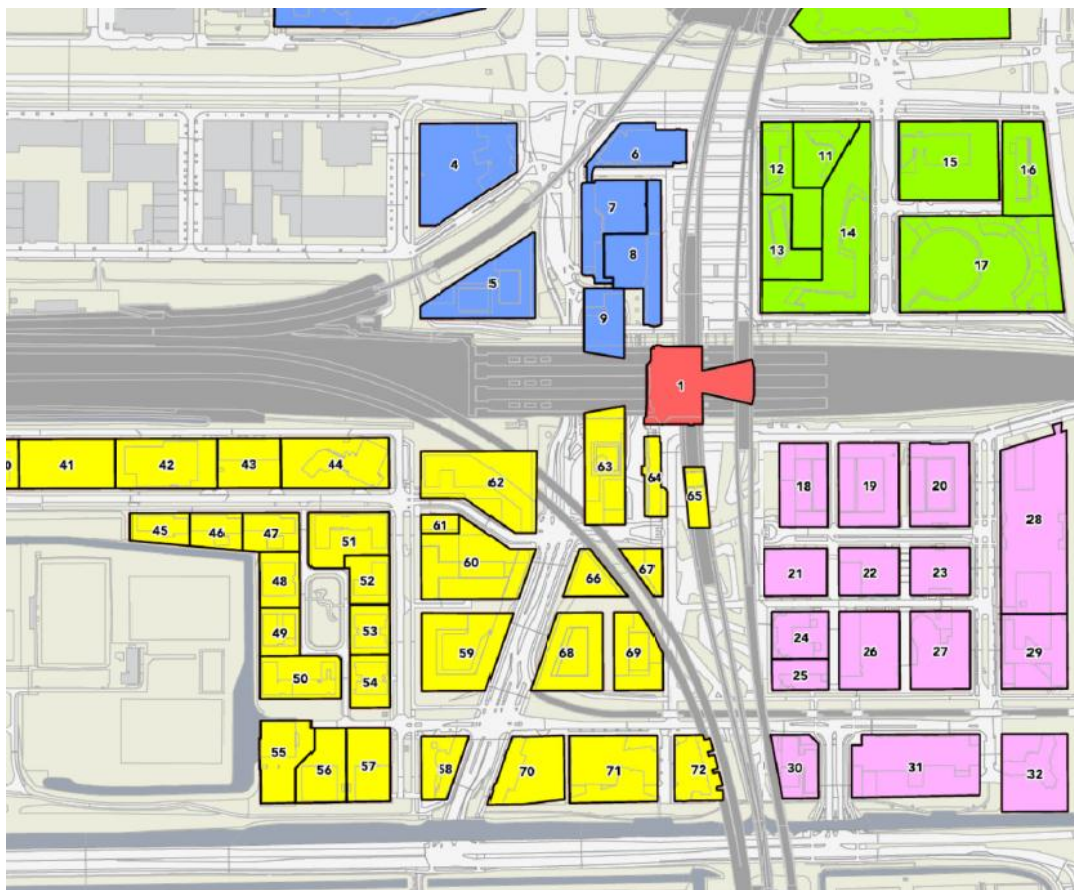

Waarneempunt 18

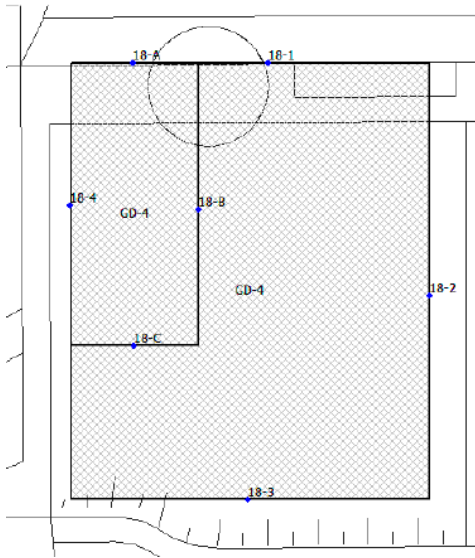

Waarneempunt 19

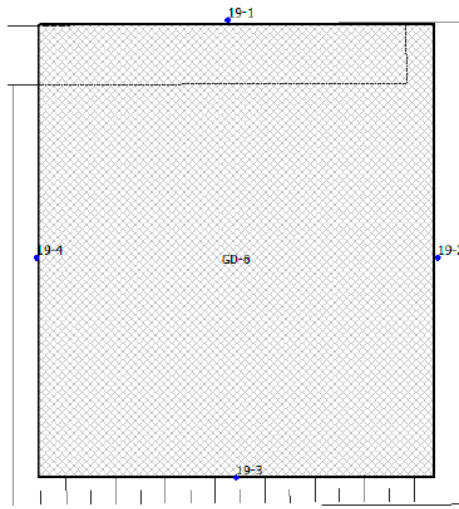

Waarneempunt 20

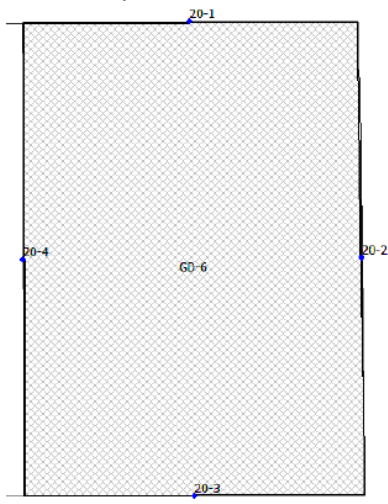

Waarneempunt 21

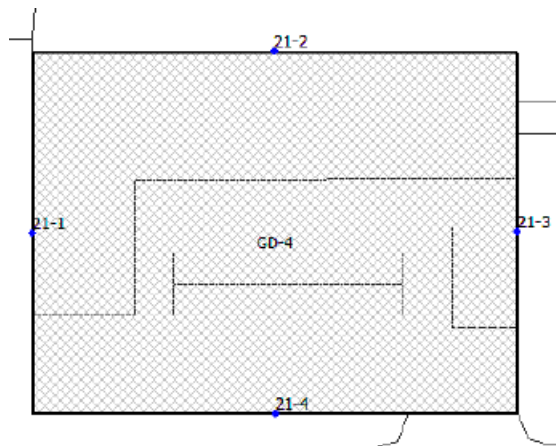

Waarneempunt 22

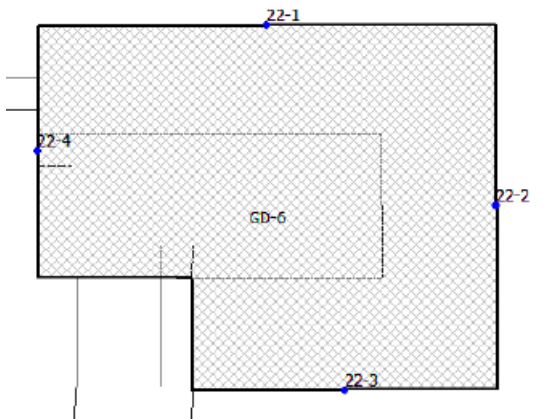

Waarneempunt 24/25

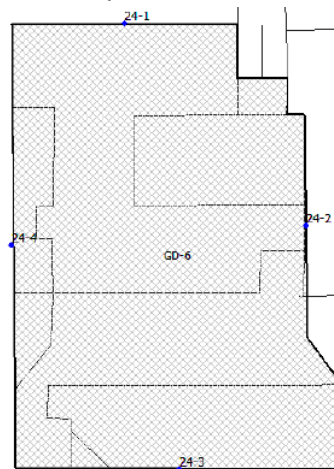

Waarneempunt 44

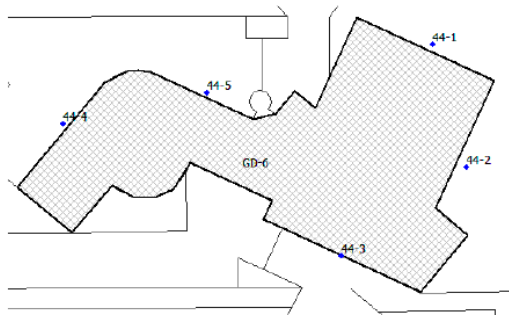

Waarneempunt 49

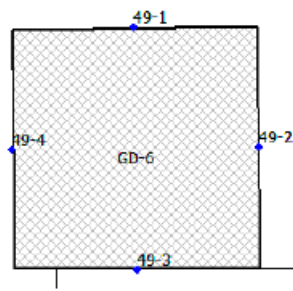

Waarneempunt 50

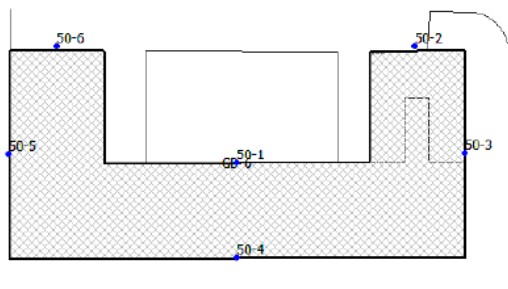

Waarneempunt 51

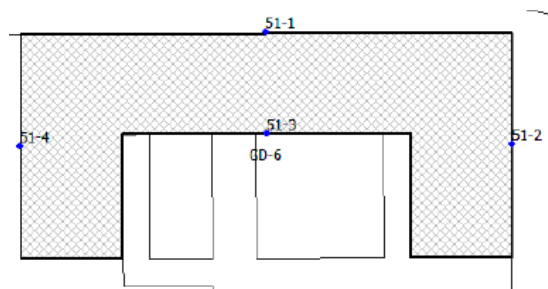

Waarneempunt 59

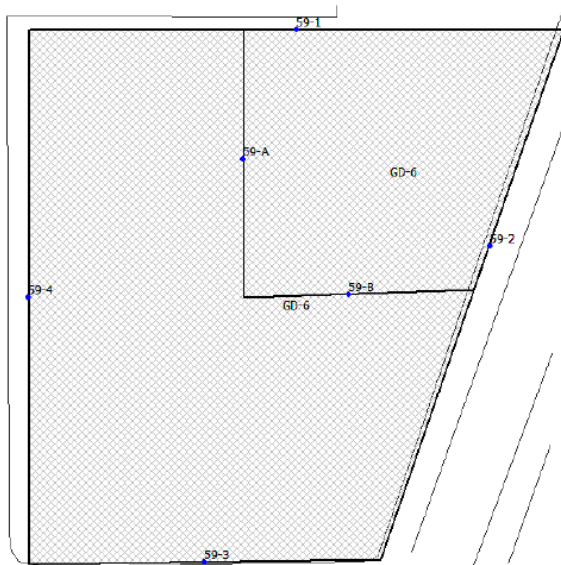

Waarneempunt 60

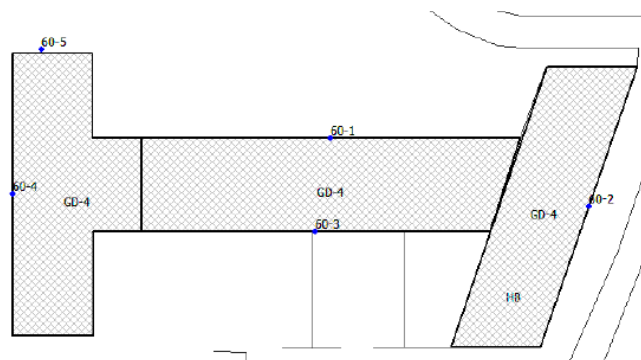

Waarneempunt 62

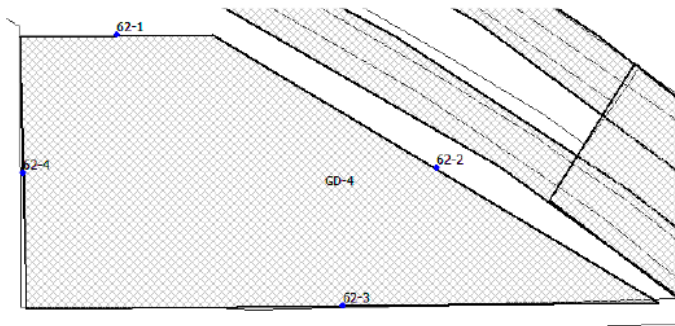

Waarneempunt 63

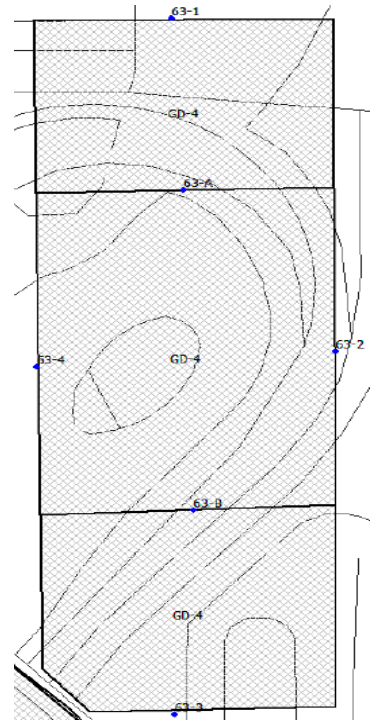

Waarneempunt 64

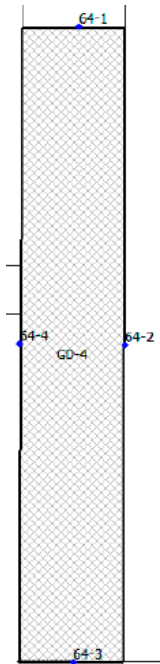

Waarneempunt 66/67

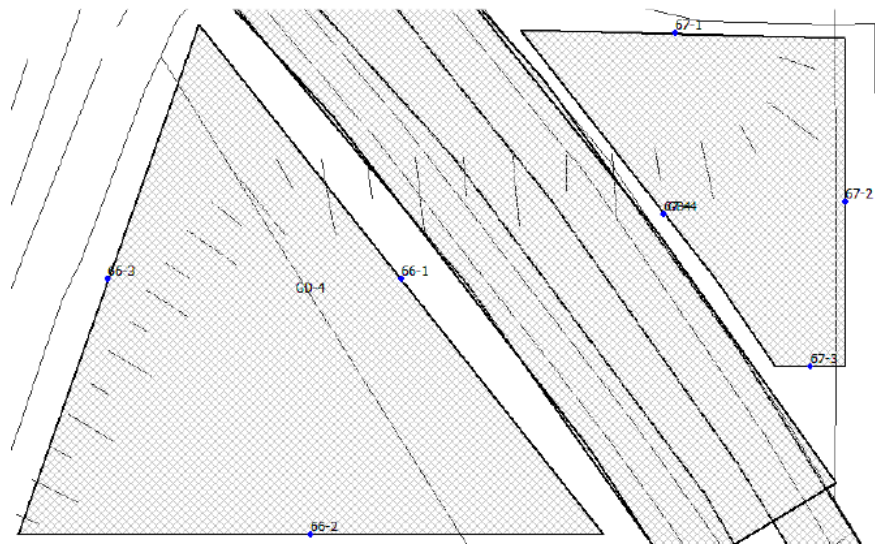

Waarneempunt 68/69

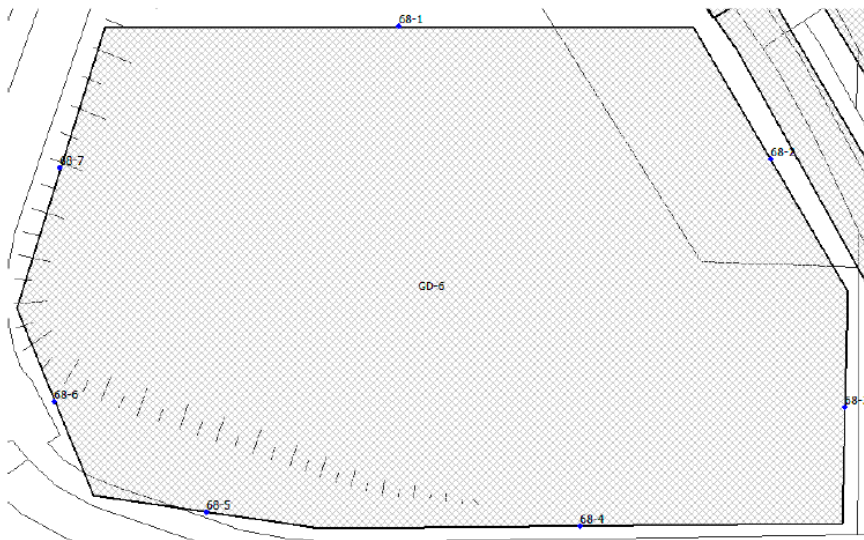

Lijst dove gevels bij maximale benutting kavels (reeds bebouwde en lege kavels)

wnp	hoogte	wnp	hoogte	wnp	hoogte	wnp	hoogte
18 [1]_A	< 5m	21 [2]_A	< 5m	59 [4]_D	> 20m	62-2 [4]_D	> 20m
18 [1]_B	5 - 10m	21 [2]_B	5 - 10m	60-61 [1b]_C	10 - 20m	63-64 [1]_A	< 5m
18 [1]_C	10 - 20m	21 [2]_C	10 - 20m	60-61 [1b]_D	> 20m	63-64 [1]_B	5 - 10m
18 [1]_D	> 20m	21 [2]_D	> 20m	60-61 [2]_D	> 20m	63-64 [1]_C	10 - 20m
18 [2]_A	< 5m	21 [4]_B	5 - 10m	60-61 [4]_D	> 20m	63-64 [1]_D	> 20m
18 [2]_B	5 - 10m	21 [4]_C	10 - 20m	62-1 [1]_A	< 5m	63-64 [2]_B	5 - 10m
18 [2]_C	10 - 20m	21 [4]_D	> 20m	62-1 [1]_B	5 - 10m	63-64 [2]_C	10 - 20m
18 [2]_D	> 20m	24-25 [2]_B	5 - 10m	62-1 [1]_C	10 - 20m	63-64 [2]_D	> 20m
18 [4]_A	< 5m	24-25 [2]_C	> 10m	62-1 [1]_D	> 20m	63-64 [3a]_A	< 5m
18 [4]_B	5 - 10m	24-25 [4]_B	5 - 10m	62-1 [2a]_B	5 - 10m	63-64 [3a]_B	5 - 10m
18 [4]_C	10 - 20m	24-25 [4]_C	> 10m	62-1 [2a]_C	10 - 20m	63-64 [3a]_D	> 20m
18 [4]_D	> 20m	27 [3]_C	> 10m	62-1 [2a]_D	> 20m	63-64 [3b]_A	< 5m
19 [1]_A	< 5m	44 [1]_A	< 5m	62-1 [2b]_C	10 - 20m	63-64 [3b]_B	5 - 10m
19 [1]_B	5 - 10m	44 [1]_B	5 - 10m	62-1 [2b]_D	> 20m	63-64 [3b]_C	10 - 20m
19 [1]_C	10 - 20m	44 [1]_C	10 - 20m	62-1 [3a]_A	< 5m	63-64 [3b]_D	> 20m
19 [1]_D	> 20m	44 [1]_D	> 20m	62-1 [3a]_B	5 - 10m	63-64 [4]_A	< 5m
19 [2]_B	5 - 10m	44 [2]_A	< 5m	62-1 [4]_B	5 - 10m	63-64 [4]_B	5 - 10m
19 [2]_C	10 - 20m	44 [2]_B	5 - 10m	62-1 [4]_C	10 - 20m	63-64 [4]_C	10 - 20m
19 [2]_D	> 20m	44 [2]_C	10 - 20m	62-1 [4]_D	> 20m	63-64 [4]_D	> 20m
19 [4]_A	< 5m	44 [2]_D	> 20m	62-2 [1]_A	< 5m	66-69 [2]_C	10 - 20m
19 [4]_B	5 - 10m	44 [4]_B	5 - 10m	62-2 [1]_B	5 - 10m	66-69 [2]_D	> 20m
19 [4]_C	10 - 20m	44 [4]_C	10 - 20m	62-2 [1]_C	10 - 20m	66-69 [3]_D	> 20m
19 [4]_D	> 20m	44 [4]_D	> 20m	62-2 [1]_D	> 20m	67 [1]_D	> 20m
20 [1]_A	< 5m	48-50 [4]_B	5 - 10m	62-2 [2]_D	> 20m	67 [2]_B	5 - 10m
20 [1]_B	5 - 10m	59 [1]_D	> 20m	62-2 [4]_A	< 5m	67 [2]_C	10 - 20m
20 [1]_C	10 - 20m	59 [2]_A	< 5m	62-2 [4]_B	5 - 10m	67 [2]_D	> 20m
20 [1]_D	> 20m	59 [3]_D	> 20m	62-2 [4]_C	10 - 20m		

